

**ITEM 21. ITEM FOR COMMITTEE INFORMATION – TRAFFIC TREATMENT –
WENTWORTH AVENUE FROM OXFORD LIVERPOOL COLLEGE
STREETS TO ELIZABETH STREET SYDNEY**

TRIM RECORD NO: 2015/370828

RECOMMENDATION

It is recommended that the Committee endorse the following:

- (A) Provide two right turn lanes, two through lanes and a northbound left and through lane on Wentworth Avenue between 17.6 metres north of Commonwealth Street and Liverpool Street;
- (B) Provide three southbound lanes and a right turn lane on Wentworth Avenue between Wemyss Lane and Goulburn Street;
- (C) Provide three northbound lanes and a 50 metre right turn lane on Wentworth Avenue between 65 metres north of the building line with Elizabeth Street to Goulburn Street;
- (D) Provide a signalised pedestrian crossing on Goulburn Street and across the slip lane immediately west of Wentworth Avenue;
- (E) Provide three northbound lanes on Wentworth Avenue between Elizabeth Street and Goulburn Avenue;
- (F) Provide two southbound lanes and a left turn lane on Wentworth Avenue between Hunt Street and Campbell Street;
- (G) Reallocation of kerb space on Wentworth Avenue between Oxford Street and Wemyss Lane as “No Stopping”;
- (H) Reallocation of kerb space on the eastern side of Wentworth Avenue between points 4.8 metres and 10 metres south of the building alignment of Wemyss Lane to “No Stopping, Taxis Excepted (Limit 1 minute)”;
- (I) Reallocation of kerb space on the eastern side of Wentworth Avenue between points 10 metres and 94.3 metres south of the building alignment of Wemyss Lane to “No Stopping 6am-10am 3pm-8pm Mon-Fri”, “Loading Zone Ticket 10am-3pm Mon-Fri, 6am-10am Sat” and “4P Ticket 8pm-12am Mon-Fri, 10am-10pm Sat, 8am-10pm Sun & Public Holidays”;
- (J) Reallocate the kerb space on the eastern side of Wentworth Avenue between points 94.3 metres and 102.79 metres south of the building alignment on Wemyss Lane to “No Stopping 6am-10am 3pm-8pm Mon-Fri” and “P15 minutes 10am-3pm Motorbikes Only”;
- (K) Reallocation of kerb space parking on the eastern side of Wentworth Avenue between the points 102.8 metres and 119.2 metres south of the building alignment on Wemyss Lane as “No Stopping 6am-10am 3pm-8pm Mon-Fri”, “Loading Zone Ticket 10am-3pm Mon-Fri, 6am—10am Sat” and “4P Ticket 8pm-12am Mon-Fri, 10am-10pm Sat, 8am-10pm Sun & Public Holidays”;
- (L) Reallocation of kerb space on the eastern side of Wentworth Avenue between Commonwealth Street and Hunt Street to “No Stopping”;
- (M) Reallocation of kerb space on the eastern side of Wentworth Avenue between points 2.44 metres and 7.48 metres south of the southern building alignment of Hunt Street to “No Stopping”;

- (N) Reallocation of kerb space on eastern side of Wentworth Avenue between points 7.48 metres and 38.48 metres south of the southern building alignment of Hunt Street to “No Stopping 6am-10am 3pm-8pm Mon-Fri”, “Loading Zone Ticket 10am-3pm Mon-Fri, 6am-10am Sat” and “4P Ticket 8pm-12am Mon-Fri, 10am-10pm Sat, 8am-10pm Sun & Public Holidays”;
- (O) Reallocation of kerb space on eastern side of Wentworth Avenue between points 38.48 metres and 47.96 metres south of the building alignment of Hunt Street to “No Stopping 6am-10am 3pm-8pm Mon-Fri” and “No Parking Other Times”;
- (P) Reallocation of kerb space on eastern side of Wentworth Avenue between points 48.0 metres and 101.5 metres south of the building alignment of Hunt Street to “No Stopping 6am-10am 3pm-8pm Mon-Fri”, “Loading Zone Ticket 10am-3pm Mon-Fri, 6am-10am Sat” and “4P Ticket 8pm-12am Mon-Fri, 10am-10pm Sat, 8am-10pm Sun & Public Holidays”;
- (Q) Reallocation of kerb space on eastern side of Wentworth Avenue between points 101.53 metres and 112.55 metres south of the building alignment of Hunt Street to “No Stopping”;
- (R) Reallocation of kerb space on western side of Wentworth Avenue between points 0.00 metres and 14.23 metres north of the building alignment of Elizabeth Street to “No Stopping Aust. Post Vehicles Excepted”;
- (S) Reallocation of kerb space on western side of Wentworth Avenue between points 14.23 metres and 23.56 metres north of the building alignment of Elizabeth Street to “No Parking Coaches Excepted 15 Minute Limit”;
- (T) Reallocation of kerb space on the western side of Wentworth Avenue between points 23.56 metres and 30.07 metres north of the building alignment of Elizabeth Street to “Loading Zone Ticket 6am-6pm Mon-Fri, 6am-10am Sat”;
- (U) Reallocation of kerb space on the western side of Wentworth Avenue between points 40.32 metres and 62.25 metres north of the northern building alignment of Elizabeth Street to “Loading Zone Ticket 6am-6pm Mon-Fri, 6am-10am Sat” and “4P Ticket 6pm-10pm Mon-Fri, 10am-10pm Sat, 8am-10pm Sun & Public Holidays”;
- (V) Reallocation of kerb space on the western side of Wentworth Avenue between points 62.25 metres and 93.34 metres north of the northern building alignment of Elizabeth Street to “No Stopping”;
- (W) Reallocation of kerb space on the western side of Wentworth Avenue between Commonwealth Street and 14.8 metres north of the prolongation of the building alignment of Commonwealth Street as “No Stopping”;
- (X) Reallocation of kerb space on the western side of Wentworth Avenue between points 14.8 metres and 49.3 metres north of the prolongation of the eastern building alignment of Commonwealth Street as “No Stopping 6am-10am, 3pm-8pm Mon-Fri”, “Loading Zone Ticket 10am-3pm Mon-Fri, 6am-10am Sat” and “1P Ticket Other times CBD Permit Holders Excepted”;
- (Y) Reallocation of kerb space on the western side of Wentworth Avenue between a point 49.3 metres north of the prolongation of the eastern building alignment of Commonwealth Street and Lyons Lane as “No Stopping”;
- (Z) Reallocation of kerb space on western side of Wentworth Avenue between Lyons Lane and a point 14.4 metres north of the northern building alignment of Lyons Lane as “No Stopping”;

- (AA) Reallocation of kerb space on the western side of Wentworth Avenue between points 14.4 metres and 43.9 metres north of the northern building alignment of Lyons Lane as “No Stopping 6am-10am 3pm-8pm Mon-Fri”, “Loading Zone Ticket 10am-3pm Mon-Fri, 6am-10am Sat” and “4P Ticket 8pm-12am Mon-Fri, 10am-10pm Sat, 8am-10pm Sun & Pub Holidays” and “No Stopping” north to Liverpool Street; and
- (BB) Changes the traffic signal design at Wentworth Avenue, Goulburn, Hunt, and Commonwealth Streets which will be subject to final approval by the Roads and Maritime Services.

DECISION

The Committee carried the recommendation unanimously out-of-session on 1 October 2015.

BACKGROUND

The Sydney City Centre Capacity Improvement Program (SCCCIP) is a NSW Government initiative to temporarily manage congestion within the Sydney CBD through improved road infrastructure, retaining vehicle capacity and reducing congestion in the City during the construction of the Sydney CBD and South East Light Rail Project (CSELR).

The SCCCIP will be delivered by Roads and Maritime Services (RMS) and includes:

- Modifying and realigning traffic lanes;
- Introducing changes to kerbside uses;
- Temporarily removing kerb extensions;
- Temporarily reducing footpath widths;
- Traffic signal modifications; and
- Modifying or removing some on-street parking.

The proposals set out as part of the SCCCIP will be reviewed six months after implementation to ensure effective operation of the changes. Following commencement of services for the CBD and South-East Light Rail, and following consultation between the City and RMS, any measures reducing pedestrian and cyclist accessibility will be reinstated by RMS at full cost.

COMMENTS

The kerb space on Wentworth Avenue from Elizabeth Street to Oxford Street is generally signposted as Loading Zone, 1P Ticket.

The proposed parking change seeks support realign the lane configuration to provide a kerbside travel lane, lane amendments and associated parking changes.

CONSULTATION

The RMS publically exhibited the Review of Environmental Factors (REF), from 24 November 2014 to 9 January 2015. Notification of the REF included a letterbox drop to 42,000 residents and businesses including about 400 letters to key stakeholders, businesses and residents located adjacent to the various individual proposals.

There were a total of 122 submissions in response to the REF. 104 submission were opposed to the proposal, nine submissions were in support of the proposal.

The submissions in support of the proposal were in favour of increased vehicle capacity in the CBD. The submissions opposed to the proposal were opposed to the reduction in pedestrian space.

FINANCIAL

Implementation of all works associated with the SCCCIP including any restoration works required following the implementation of the CSELR, will be fully funded by the NSW State Government.

ATTACHMENTS

Item for Committee Information – Traffic Treatment – Wentworth Avenue from Oxford Liverpool and College Streets to Elizabeth Street, Sydney

Stephen Sherwin, Project Manager – Roads and Maritime Services

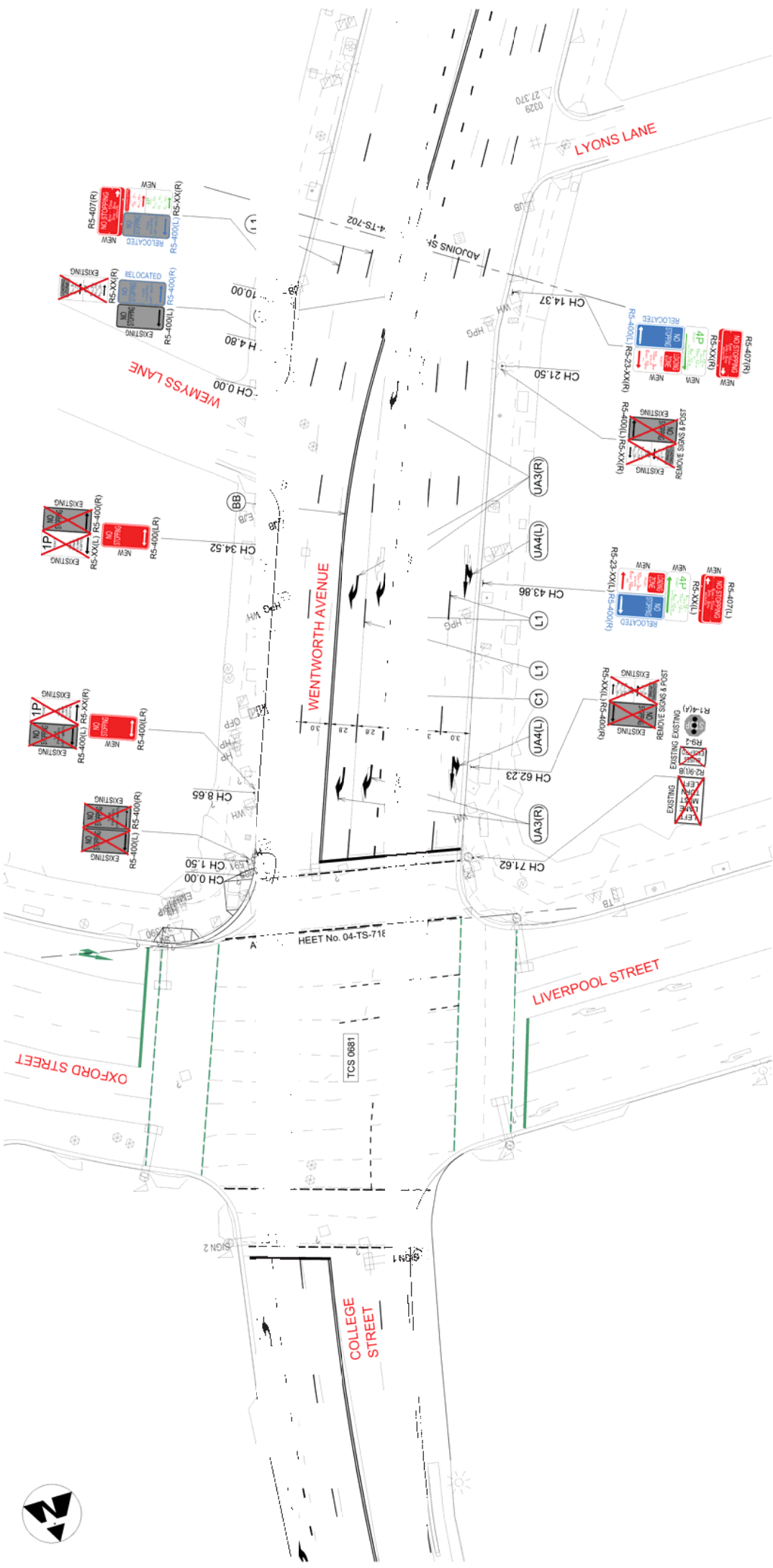

REVISIONS

REV	DESCRIPTION	DATE	DESIGNER	CHECKED	APP'D
01	ISSUED FOR CONSTRUCTION	20.05.15	AO	RW	RM

GENERAL NOTES

1. DO NOT SCALE DRAWINGS. DIMENSIONS HAVE PREFERENCE OVER SCALED DIMENSIONS.
2. ANY DIMENSIONS MUST BE REPORTED IMMEDIATELY TO THE SUPERINTENDENT.
3. ALL DIMENSIONS TO BE REPORTED IMMEDIATELY TO THE SUPERINTENDENT.
4. LOCATE AND PROTECT ALL UNDERGROUND SERVICES PRIOR TO ANY EXCAVATION. MAKE GOOD ALL DAMAGE TO EXISTING WORKS CAUSED BY THE ACTIVITY OF THESE WORKS.
5. THESE DRAWINGS ARE TO BE PRINTED IN COLOUR.
6. THE CONTRACTOR SHALL BE RESPONSIBLE FOR OBTAINING ALL NECESSARY PERMITS AND APPROVALS FROM THE RELEVANT AUTHORITIES PRIOR TO COMMENCING WORK.

Woolcotts.
CONSULTANTS

WSP | **PARSONS BRINCKERHOFF**

LAS
Lighting, Art & Science
Lighting Consultants, Electrical Engineers
403 Pacific Highway, PMB 1003
Sydney NSW 1502
Tel: (61) 02 9551 1235

PROJECT
SCCCP
PRECINCT 04 - COLLEGE STREET

CLIENT
GBD ALLIANCE

LINEMARKING & SIGNAGE PLAN
WENTWORTH AVENUE
SHEET 1 OF 4

DRAWING No.
02150022-04-TS-701

REV
DRN

CHD
APPD

AO
RW

RM
RM

DATE
20.05.15

SCALE
1:500

Tract
Landscape Architects
Urban Designers
Town Planners
Level 6/80 Mount Street North Sydney A.S.N. 2060
P. 02 9554 3733
www.tract.net.au

CONSTRUCTION ISSUE

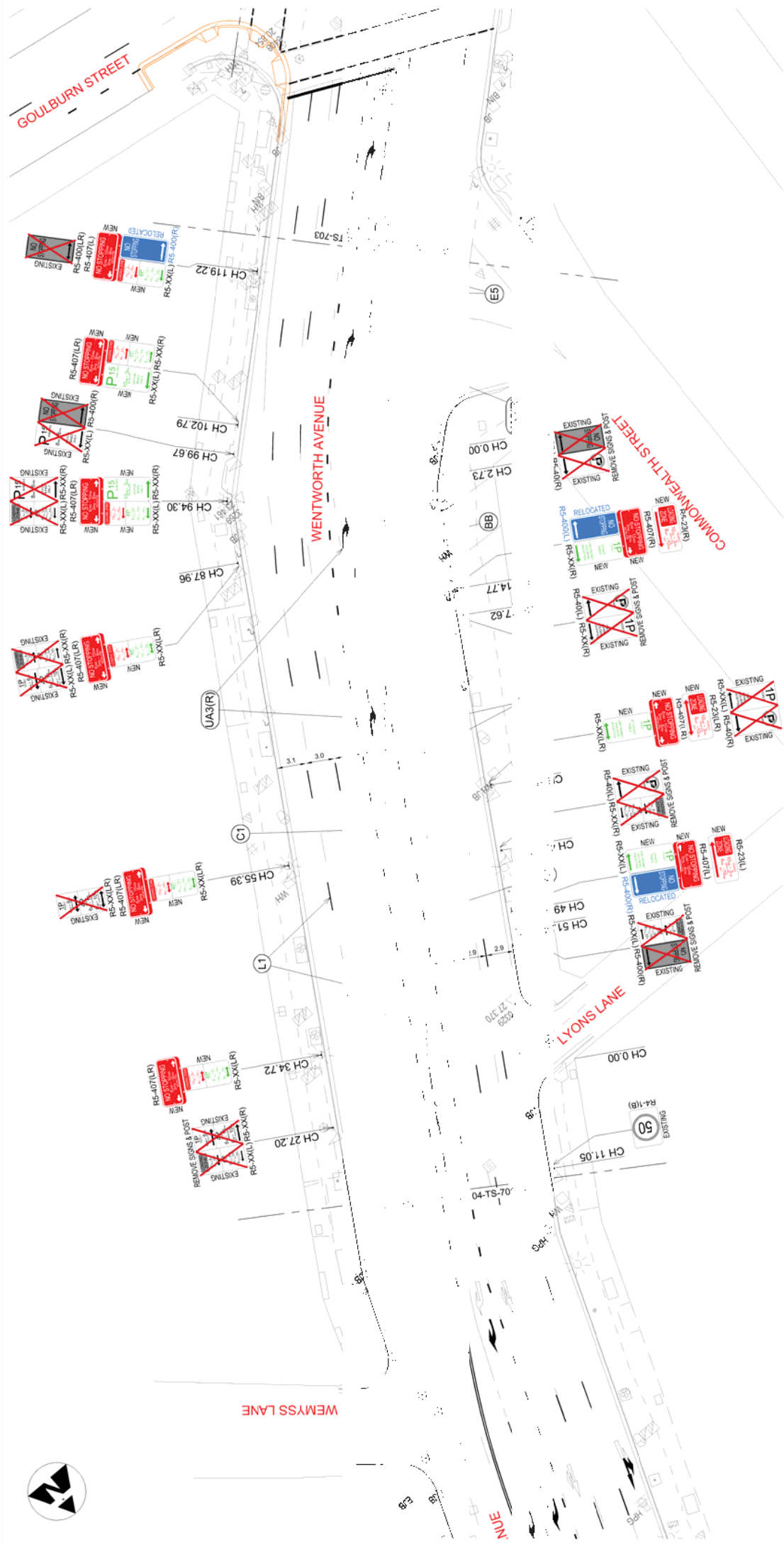

REVISIONS

REV	DESCRIPTION	DATE	DESIGN	CHKD
01	ISSUED FOR CONSTRUCTION	20.05.15	AO	RW

GENERAL NOTES

1. DON'T SCALE DRAWINGS. FIGURED DIMENSIONS HAVE PREFERENCE OVER SCALED DIMENSIONS.
2. ANY REFERENCES MUST BE REFERRED IMMEDIATELY TO THE SUPERINTENDENT.
3. ALL DIMENSIONS MUST BE READ IN CONNECTION WITH THE DETAIL SPECIFICATION AND DIMENSIONAL DOCUMENTS.
4. LOCATE AND PROTECT ALL UNDERGROUND SERVICES PRIOR TO ANY EXCAVATION. MAKE GOOD ALL DAMAGE TO EXISTING WORKS CAUSED BY THE ACTIVITY OF THESE WORKS.
5. THESE DRAWINGS ARE TO BE PRINTED IN COLOUR.

THESE DRAWINGS AND THE WORKS TO BE UNDERTAKEN HEREON ARE THE PROPERTY OF TRACT CONSULTANTS PTY LTD. THEY ARE NOT TO BE REPRODUCED, COPIED, REPRODUCED, OR USED FOR ANY OTHER PURPOSE WITHOUT THE WRITTEN PERMISSION OF TRACT CONSULTANTS PTY LTD.

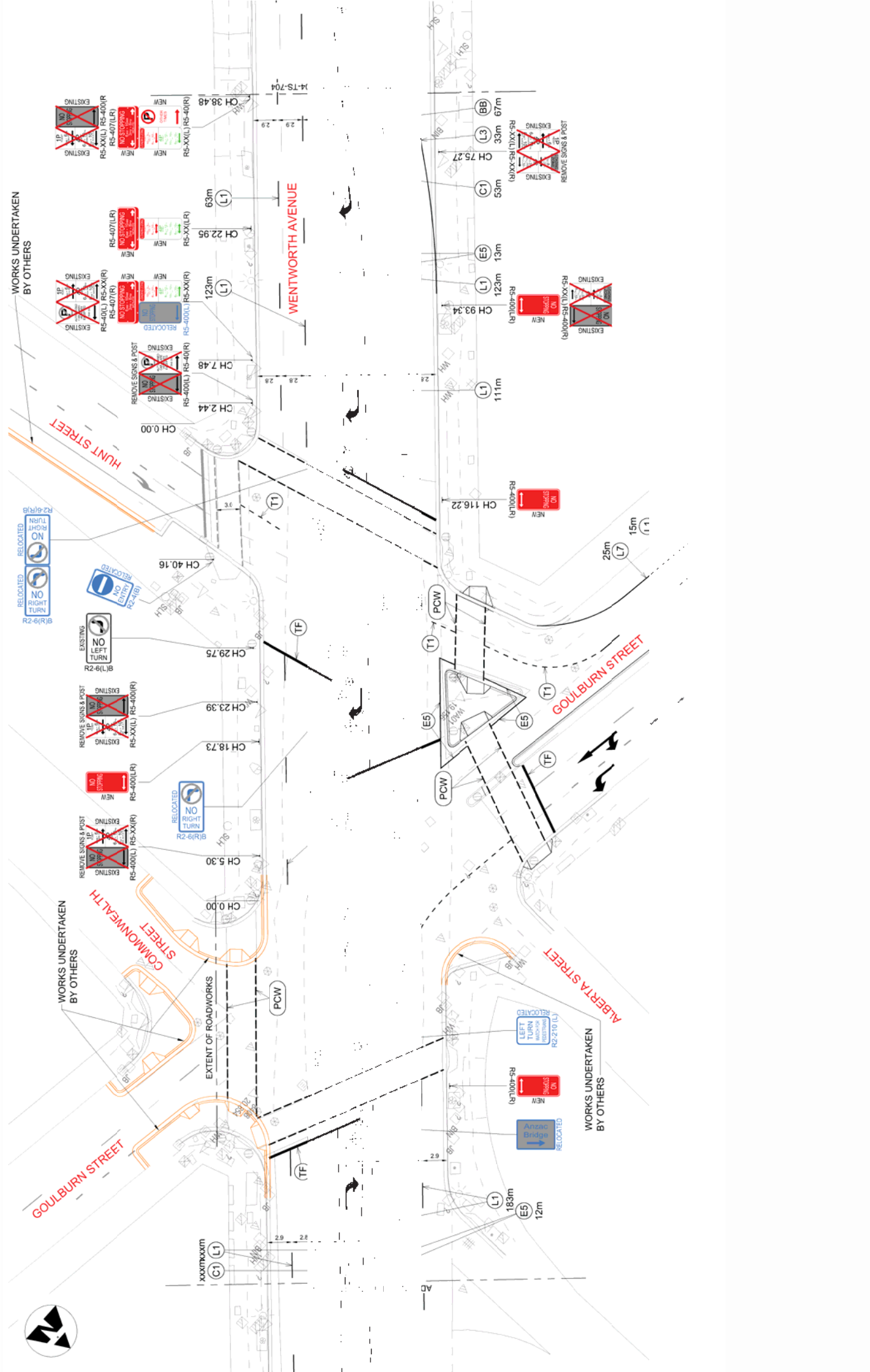

REVISIONS

NO	DESCRIPTION	DATE	SCALE	CHD
01	ISSUED FOR CONSTRUCTION	20.05.15	1:1	RM
02	ISSUED FOR CONSTRUCTION			

GENERAL NOTES

- DO NOT SCALE DRAWINGS. DIMENSIONS HAVE PREFERENCE OVER SCALED DIMENSIONS.
- ANY DIMENSIONS MUST BE REFERRED IMMEDIATELY TO THE SUPERINTENDENT.
- THE ROAD TO BE OPENED IN CONNECTION WITH THE DE LAHAYE ROADWORKS AND ENGINEERING DOCUMENTS.
- LOCATE AND PROTECT ALL UNDERGROUND SERVICES PRIOR TO ANY EXCAVATION. MAKE GOOD ALL DAMAGE TO EXISTING WORKS CAUSED BY THE ACTIVITY OF THESE WORKS.
- THESE DRAWINGS ARE TO BE PRINTED IN COLOURS.

PROJECT: SCCCIP PRECINCT 04 - COLLEGE STREET

CLIENT: GBD ALLIANCE

CONSTRUCTION ISSUE

DATE: 20.05.15

SCALE: 1:100

LINE MARKING & SIGNAGE PLAN
WENTWORTH AVENUE
SHEET 3 OF 4

DRAWING No: 02150022-04-TS-703

REV: 01

CHD: RM

APPD: RM

DATE: 20.05.15

Tract
Landscape Architects
Urban Designers
Town Planners
Level 8/80 Mount Street North Sydney N.S.W. 2060
P. 02 9554 3733
www.tract.net.au

Woolcotts
CONSULTANTS
100/102 Pitt Street
Sydney NSW 2000
Phone: (02) 9222 2700
Fax: (02) 9222 2701
www.woolcotts.com.au

WSP
100/102 Pitt Street
Sydney NSW 2000
Phone: (02) 9222 2700
Fax: (02) 9222 2701
www.wsp.com.au

PARSONS BRINCKERHOFF
100/102 Pitt Street
Sydney NSW 2000
Phone: (02) 9222 2700
Fax: (02) 9222 2701
www.parsonsbrinckerhoff.com.au

LAS
Lighting, Art & Science
Lighting Consultants, Electrical Engineers
4/10 Pacific Highway, PARRAMATTA 2073
Phone: (02) 9614 1674, 02 9614 1625
www.las.com.au

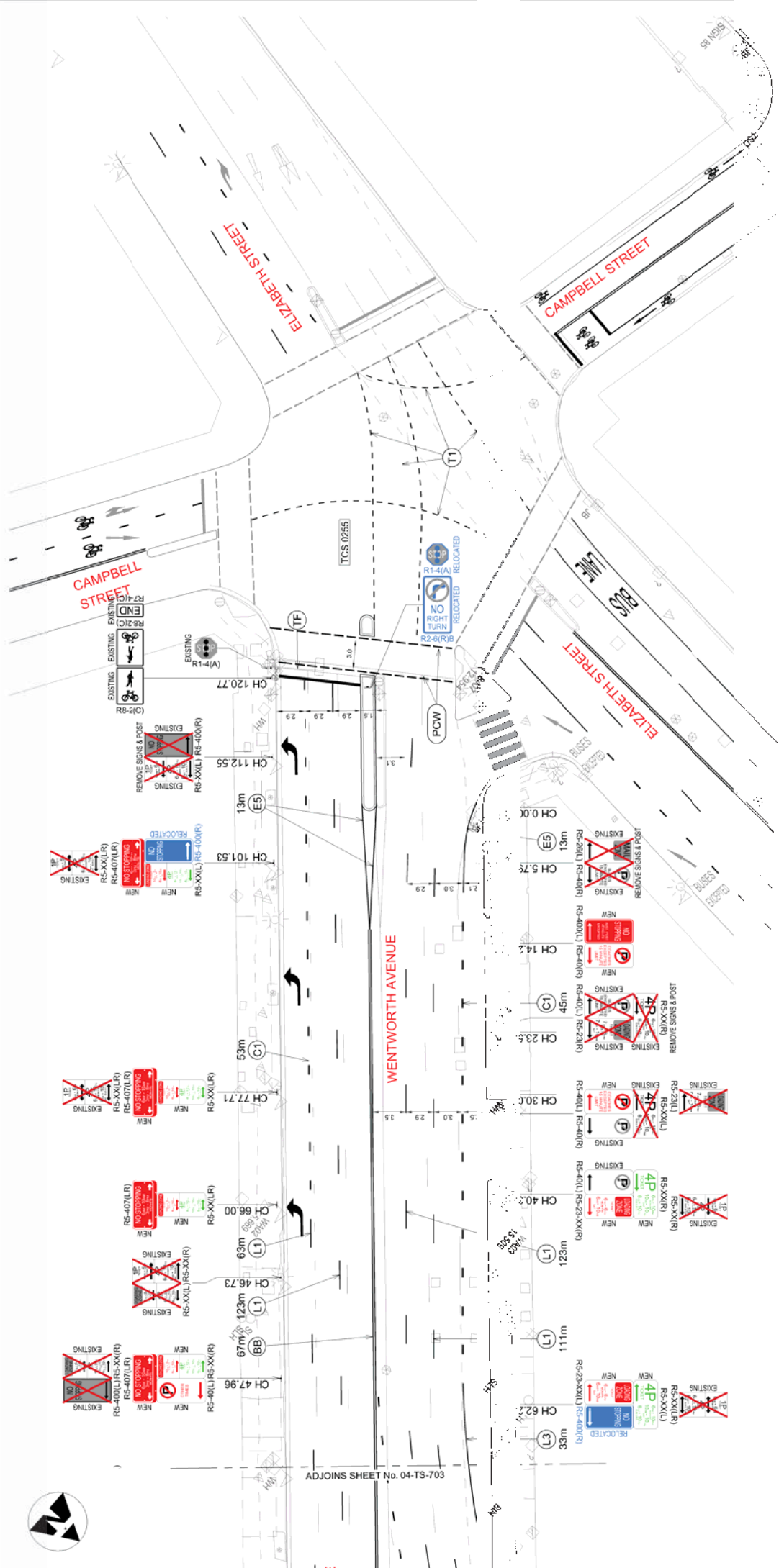

REVISIONS

NO.	DATE	BY	CHKD	DESCRIPTION
1	20.05.15	AO	RM	ISSUED FOR CONSTRUCTION
2	12.05.14	AO	RM	REVISED FOR CONSTRUCTION

GENERAL NOTES

1. DON'T SCALE DRAWINGS - FIGURED DIMENSIONS HAVE PREFERENCE OVER SCALED DIMENSIONS
2. ANY REFERENCES MUST BE REFERRED IMMEDIATELY TO THE SUPERINTENDENT
3. ALL DIMENSIONS MUST BE REFERRED TO THE SUPERINTENDENT
4. ENGINEERING DOCUMENTS MUST BE REFERRED TO THE SUPERINTENDENT
5. LOCATE AND PROTECT ALL UNDERGROUND SERVICES PRIOR TO ANY EXCAVATION. MAKE GOOD ALL DAMAGE TO EXISTING WORKS CAUSED BY THE ACTIVITY OF THESE WORKS.
6. THESE DRAWINGS ARE TO BE PRINTED IN COLOUR
7. THE CONTRACTOR SHALL BE RESPONSIBLE FOR OBTAINING ALL NECESSARY PERMITS AND APPROVALS FROM THE RELEVANT AUTHORITIES
8. THE CONTRACTOR SHALL BE RESPONSIBLE FOR OBTAINING ALL NECESSARY PERMITS AND APPROVALS FROM THE RELEVANT AUTHORITIES

PROJECT
 SCCPCP
 PRECINCT 04 - COLLEGE STREET

CLIENT
 GBD ALLIANCE

LINEMARKING & SIGNAGE PLAN
 WENTWORTH AVENUE
 SHEET 4 OF 4

DRAWING No. 02150022-04-TS-704
REV 01
DRN AO
CHKD RW
APPD RM

DATE 20.05.15

SCALE 1:200 (A1)

Tract
Tract Architects
Landscape Architects
Urban Designers
Town Planners
 Level 6/80 Mount Street North Sydney A.S.N. 2060
 P. 02 9554 3733
 www.tract.com.au

Woolcotts.
 CONSULTANTS
 100/102 Pitt Street Sydney NSW 2000
 Phone: (02) 9222 2100
 Fax: (02) 9222 2101
 Email: info@woolcotts.com.au
 Website: www.woolcotts.com.au

WSP
 CONSULTANTS
 100/102 Pitt Street Sydney NSW 2000
 Phone: (02) 9222 2100
 Fax: (02) 9222 2101
 Email: info@wsp.com.au
 Website: www.wsp.com.au

PARSONS BRINCKERHOFF
 CONSULTANTS
 100/102 Pitt Street Sydney NSW 2000
 Phone: (02) 9222 2100
 Fax: (02) 9222 2101
 Email: info@parsonsbrinckerhoff.com.au
 Website: www.parsonsbrinckerhoff.com.au

LAS
 Lighting, Art & Science
 Lighting Consultants, Electrical Engineers
 100/102 Pitt Street Sydney NSW 2000
 Phone: (02) 9222 2100
 Fax: (02) 9222 2101
 Email: info@las.com.au
 Website: www.las.com.au